

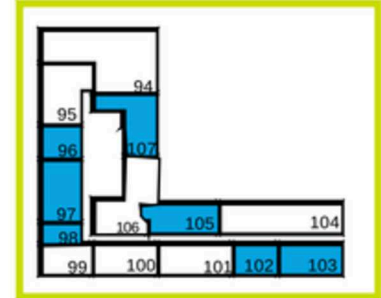

DETAIL 1



DETAIL 2



DETAIL 3

Availability

**LEASING REPRESENTATIVE**

**JASON LEE**

(949) 252-3876 | jlee@kimcorealty.com

Disclaimer: This site plan shows the approximate location, square footage, and configuration of the shopping center and adjacent areas, and is only illustrative of the size and relationship of the stores and common areas generally, all of which are subject to change. The showing of any names of tenants, parking spaces, square footage, curb-cuts or traffic controls shall not be deemed to be a representation or warranty that any tenants will be at the shopping center, the square footage is accurate, or that any parking spaces, curb-cuts or traffic controls do or will continue to exist. Moreover, any demographics set forth in this flyer are for illustrative purposes only and shall not be deemed a representation by Landlord or their accuracy. Availability of this property for rent is subject to prior rental or withdrawal of the property from the market at any time without notice.

| TENANT |                                | SQFT    | TENANT |                                | SQFT   | TENANT |                                   | SQFT   |
|--------|--------------------------------|---------|--------|--------------------------------|--------|--------|-----------------------------------|--------|
| K165   | Target                         |         | 54     | Five Rivers Indian Cuisine     | 2,000  | 107    | Available                         | 1,312  |
| 1      | Yong In Martial Arts           | 1,436   | 55     | Baskin-Robbins                 | 980    | 108    | Jayson Lo, DMD                    | 2,480  |
| 2      | Dae Jang Guem Tofu House       | 2,327   | 56     | DSW Shoe Warehouse             | 17,280 | 109    | Available                         | 987    |
| 3      | Ming Yuan Restaurant           | 7,161   | 57     | Walgreens                      | 30,745 | 110    | Vivien Hernandez, MD              | 600    |
| 4      | Kumon Math & Reading Center    | 3,500   | 58     | GNC                            | 1,343  | 111    | Available                         | 486    |
| 5      | Bikram Hot Yoga                | 4,100   | 59     | Target                         | 27,777 | 112    | Westlake Hearing Aid Center       | 753    |
| 6      | Bangkok Garden Restaurant      | 1,980   | 60     | Joann                          | 22,900 | 113    | Available                         | 527    |
| 7      | U.S. Postal Service            | 3,175   | 61     | San Mateo Credit Union         | 4,445  | 114    | Available                         | 485    |
| 8      | Expression Hair Design         | 1,100   | 62     | Trader Joe's                   | 14,040 | 115    | Dr. Mark Nii                      | 1,650  |
| 9      | Available                      | 1,275   | 63     | Available                      | 1,342  | 116    | Caladrius Healing Clinic          | 750    |
| 10     | H&R Block                      | 1,500   | 64     | Color Me Mine                  | 1,460  | 117    | Jiahua Zhu DDS                    | 1,038  |
| 11     | Let's Beauty                   | 1,125   | 65     | Kick City                      | 1,460  | 118    | Available                         | 708    |
| 12     | Amami San Ramen                | 1,350   | 66     | Daly City Public Library       | 2,500  | 119    | Available                         | 620    |
| 13     | Quickly USA                    | 1,370   | 67     | Beit Rima                      | 1,935  | 120    | Eilene Espina, DMD                | 457    |
| 14     | Westlake Laundry               | 3,000   | 68     | Blue Line Pizza                | 2,978  | 121    | Massage Envy                      | 2,885  |
| 15     | ARCO                           | 18,731  | 69     | Spiral Sushi & Grill           | 3,000  | 122    | Westlake Nail Spa Salon           | 1,825  |
| 16     | Burlington                     | 55,000  | 70     | Panda Express                  | 2,970  | 123    | Wingstop Restaurant               | 2,755  |
| 17     | Cesari, Werner and Moriarty    | 6,471   | 71     | Safeway                        | 57,817 | 124    | Nothing Bundt Cakes               | 1,790  |
| 18     | Available                      | 13,111  | 72     | Ross                           | 39,050 | 125    | Available                         | 930    |
| 19     | Available                      | 2,014   | 73     | Mattress Firm                  | 4,206  | 126    | Tasty Pot Restaurant              | 2,755  |
| 20     | Kimco Office                   | 5,651   | 74     | Sprint PCS                     | 2,669  | 127    | Fitness 19                        | 11,400 |
| 21     | National Asian American Coalit | 5,600   | 75     | Available                      | 2,000  | 128    | SOMA AEC, Inc.                    | 525    |
| 22     | Kaiser Permanente Hearing Ctr  | 2,810   | 76     | Cigarettes R Cheaper           | 900    | 129    | Archit Studio                     | 610    |
| 23     | Union Bank                     | 2,313   | 77     | Structure Hair Design          | 1,070  | 130    | Kinstan Home Solutions            | 200    |
| 24     | Pho Huynh Hiep III             | 2,700   | 78     | Westlake Art and Frame         | 540    | 131    | Available                         | 200    |
| 25     | Patelco Credit Union           | 2,606   | 79     | Westlake Shoe & Leather Repair | 460    | 132    | TWFG, Robert Diaz Insurance       | 200    |
| 26     | Bank of America                | 6,236   | 80     | Pulido's Tailor                | 490    | 133    | Available                         | 553    |
| 27     | Shaking Crab                   | 1,800   | 81     | Magic Touch Beauty Salon       | 468    | 134    | Available                         | 685    |
| 28     | HSBC Bank                      | 2,976   | 82     | Tani's Kitchen                 | 473    | 135    | Available                         | 518    |
| 29     | JPMorgan Chase Bank            | 7,800   | 83     | Elite Hair Salon               | 720    | 136    | Jackson Hewitt Tax Service        | 475    |
| 30     | Home Depot                     | 109,000 | 84     | Accuquest Hearing Centers      | 1,267  | 137    | Statewide Realty                  | 1,370  |
| 31     | Sheng Kee Bakery               | 2,813   | 85     | Nation's Giant Hamburgers      | 1,350  | 138    | Pamela Blum & Allan Pleaner       | 490    |
| 33     | European Wax Center            | 1,328   | 86     | Chipotle Mexican Grill         | 4,016  | 139    | Abdullah Income Tax               | 880    |
| 34     | Wells Fargo Home Mortgage      | 1,498   | 87     | Supercuts(SubT=Moxie MGT Group | 1,200  | 140    | Mancor Tech Corp.                 | 310    |
| 35     | Titika Active Couture          | 1,338   | 88     | AT&T Mobility                  | 2,177  | 141    | Available                         | 372    |
| 36     | Avon Beauty Center             | 1,493   | 89     | Red Wing Shoes                 | 825    | 142    | Hilary Davis MFT                  | 345    |
| 37     | Ketsourine Macarons            | 1,582   | 90     | The UPS Store                  | 2,400  | 143    | Pivoting Aspects Healthcare St    | 320    |
| 38     | Diddams Party & Toy Store      | 14,117  | 91     | Bank of the West               | 2,925  | 144    | Westlake Vision Center Optomet    | 427    |
| 39     | Available                      | 948     | 92     | Broadster Chicken              | 1,200  | 145    | PMG Appraisal Services            | 444    |
| 40     | Available                      | 3,017   | 93     | T-Mobile                       | 3,280  | 146    | National Asian American Coalition | 414    |
| 41     | Available                      | 1,763   | 94     | Luis Kong D.D.S.               | 1,687  | 147    | National Asian American Coalition | 1,320  |
| 42     | Sterling Bank & Trust          | 2,060   | 95     | Phuong Cheng, DDS              | 819    | 148    | Michael Zhen                      | 330    |
| 43     | GameStop                       | 1,432   | 96     | Available                      | 423    | 149    | Acclaim Home Care                 | 440    |
| 44     | Banana Island Restaurant       | 5,200   | 97     | Available                      | 1,453  | 150    | Jack Lin                          | 160    |
| 45     | Petco                          | 6,430   | 98     | Available                      | 342    | 151    | FSC Securities Corp.              | 285    |
| 46     | Linen Warehouse                | 5,475   | 99     | Rodolfo C. Villasin, DDS       | 520    | 152    | iPhone Repairing                  | 260    |
| 47     | Furniture Innovations          | 14,316  | 100    | Concepts Inst/Adv. Esthetics   | 648    | 153    | Michael Samson                    | 189    |
| 48     | Hella Halal                    | 1,800   | 101    | Mylene D. Gandingco, DDS       | 818    | 154    | Save U More Insurance             | 170    |
| 49     | Jamba Juice                    | 1,200   | 102    | Available                      | 477    | 155    | Shuyi Kong Wealth Management      | 174    |
| 50     | Astound Broadband              | 1,181   | 103    | Available                      | 771    | 156    | Poplar Global Wealth Managemen    | 497    |
| 51     | Starbucks Coffee               | 1,600   | 104    | All City Sleep Center          | 1,037  | 157    | Farmers Insurance                 | 250    |
| 52     | Westlake Vision Center Optomet | 1,440   | 105    | Available                      | 574    |        |                                   |        |
| 53     | Georgettes of Westlake         | 1,650   | 106    | Dr. Arash Mohammad Zadeh DDS   | 810    |        |                                   |        |

## LEASING REPRESENTATIVE

JASON LEE

(949) 252-3876 | jlee@kimcorealty.com

Disclaimer: This site plan shows the approximate location, square footage, and configuration of the shopping center and adjacent areas, and is only illustrative of the size and relationship of the stores and common areas generally, all of which are subject to change. The showing of any names of tenants, parking spaces, square footage, curb-cuts or traffic controls shall not be deemed to be a representation or warranty that any tenants will be at the shopping center, the square footage is accurate, or that any parking spaces, curb-cuts or traffic controls do or will continue to exist. Moreover, any demographics set forth in this flyer are for illustrative purposes only and shall not be deemed a representation by Landlord or their accuracy. Availability of this property for rent is subject to prior rental or withdrawal of the property from the market at any time without notice.