

0340

IVES DAIRY CROSSING

HWY. 441 (NW 2ND AVE.) & NW 199TH ST., NORTH MIAMI BEACH, FL

MANAGED BY AN AFFILIATE OF

KIMCO
REALTY



GLA: 108,795 SF

ACRES: 16







PARKING SPACES: 743

PARKING RATIO: 6.8 per 1,000 SF

MSA: Miami-Fort Lauderdale-West Palm Beach (FL)

WEB LINK: kimcorealty.com/0340

DEMOGRAPHICS

	 POPULATION	 DAYTIME POPULATION	 HOUSEHOLDS	 AVG. HH INCOME	 MED. HH INCOME	 PER CAPITA INCOME
2017 ESTIMATES						
1 MILE	24,277	20,286	8,929	\$53,393	\$45,364	\$19,769
3 MILE	188,986	173,612	63,603	\$55,283	\$42,869	\$18,670
5 MILE	545,038	518,436	192,300	\$59,488	\$43,753	\$21,120
10 MILE	1,547,470	1,506,990	562,215	\$65,074	\$45,924	\$23,775

LEASING REPRESENTATIVE

SUSANA HERNANDEZ-HAZZI

(954) 956-2116 | shazzi@kimcorealty.com

IVES DAIRY CROSSING

HWY. 441 (NW 2ND AVE.) & NW 199TH ST., NORTH MIAMI BEACH, FL

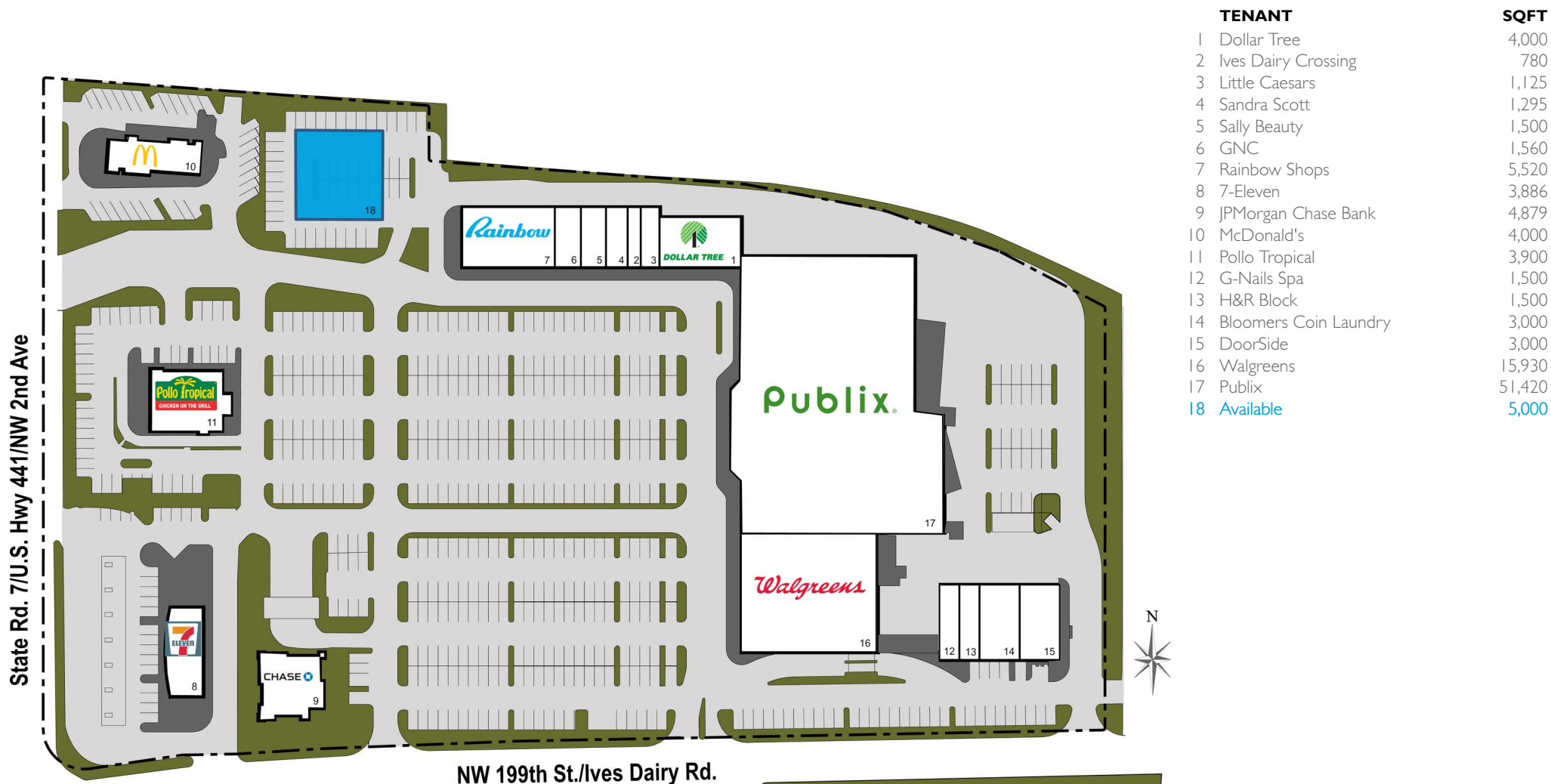

 Availability

LEASING REPRESENTATIVE

SUSANA HERNANDEZ-HAZZI

(954) 956-2116 | shazzi@kimcorealty.com

Disclaimer: This site plan shows the approximate location, square footage, and configuration of the shopping center and adjacent areas, and is only illustrative of the size and relationship of the stores and common areas generally, all of which are subject to change. The showing of any names of tenants, parking spaces, square footage, curb-cuts or traffic controls shall not be deemed to be a representation or warranty that any tenants will be at the shopping center, the square footage is accurate, or that any parking spaces, curb-cuts or traffic controls do or will continue to exist. Moreover, any demographics set forth in this flyer are for illustrative purposes only and shall not be deemed a representation by Landlord or their accuracy. Availability of this property for rent is subject to prior rental or withdrawal of the property from the market at any time without notice.